



Power Automate Error-Handling Patterns

MATTHEW DEVANEY

LAST UPDATED: 2022-10-30



Table Of Contents

- Introduction 3**
- Pattern #1: Try, Catch Finally Pattern 4**
 - Try Action 5
 - Catch Action 6
 - Finally Action 8
 - Test The Try, Catch, Finally Pattern 10
- Pattern #2: Terminate Flow Success or Failure Pattern..... 11**
 - Test The Terminate Flow Pattern..... 14
- Pattern #3: Get Flow Run Details URL Pattern..... 15**
 - Build The Flow Run Details URL 16
 - Send Failure Notification Email With Flow Run Link..... 18

Introduction

It is important to include error-handling in every Power Automate flow. When a flow fails, the owner should be notified that the flow failed. The message should say why the flow failed and [identify the flow run](#). In this article I'll share 3 Power Automate error-handling patterns you can re-use in any flow you build.

I hope you enjoy this free eBook.



Pattern #1: Try, Catch Finally Pattern

We will start by building a basic flow with 3 actions. It follows an error-handling pattern used in many other languages called *try, catch, finally pattern*.

- Try – attempt to execute a flow action
- Catch – if the flow action fails, do this action to handle the error
- Finally – run this action regardless of the result

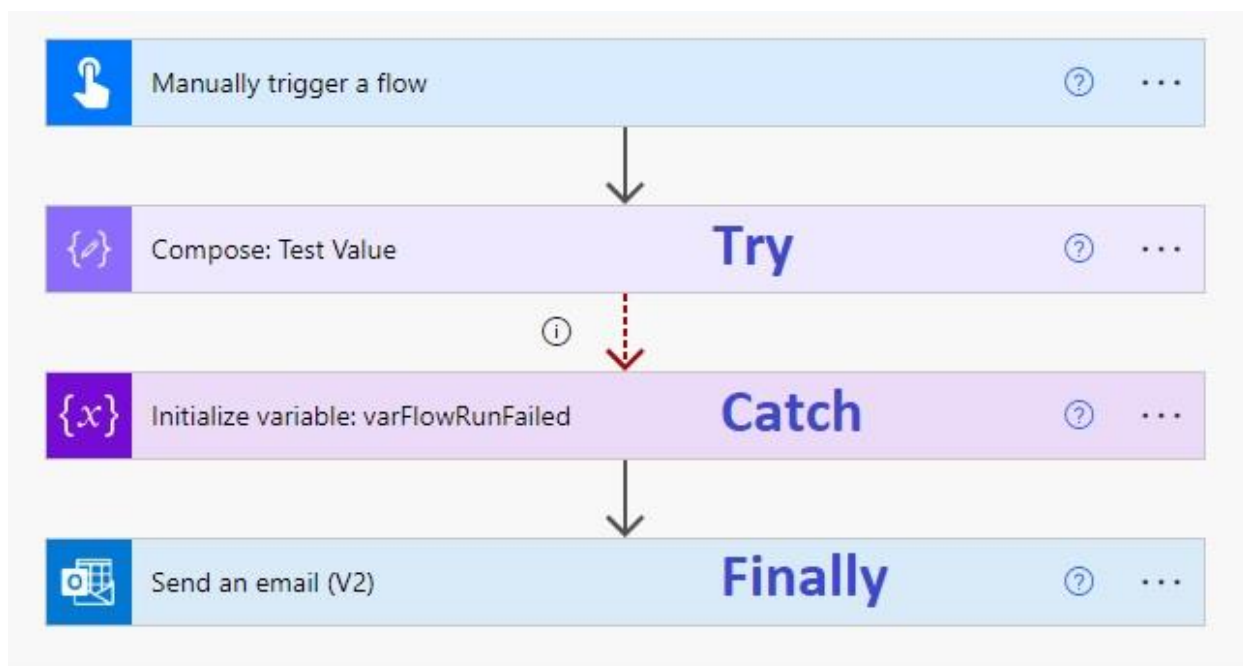

Try Action

Create a new flow with an instant trigger and add a [Compose action](#).

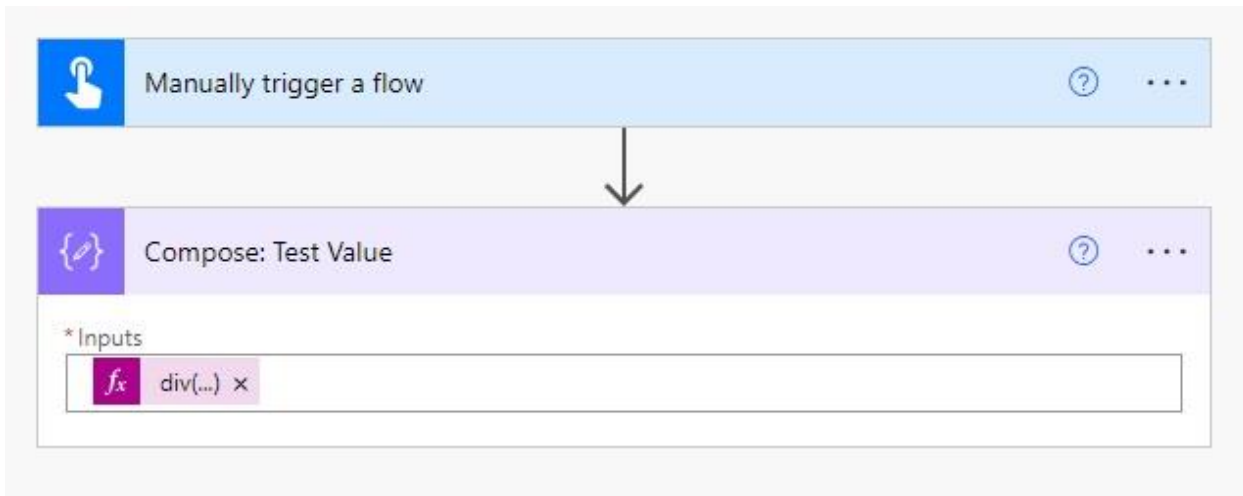

Then write this expression inside the Compose action to cause an error. Since the number 1 cannot be divided by 0 the flow action will fail.

div(1,0)

Catch Action

Next, [initialize a variable](#) called `varFlowRunFailed` to track if the flow failed.

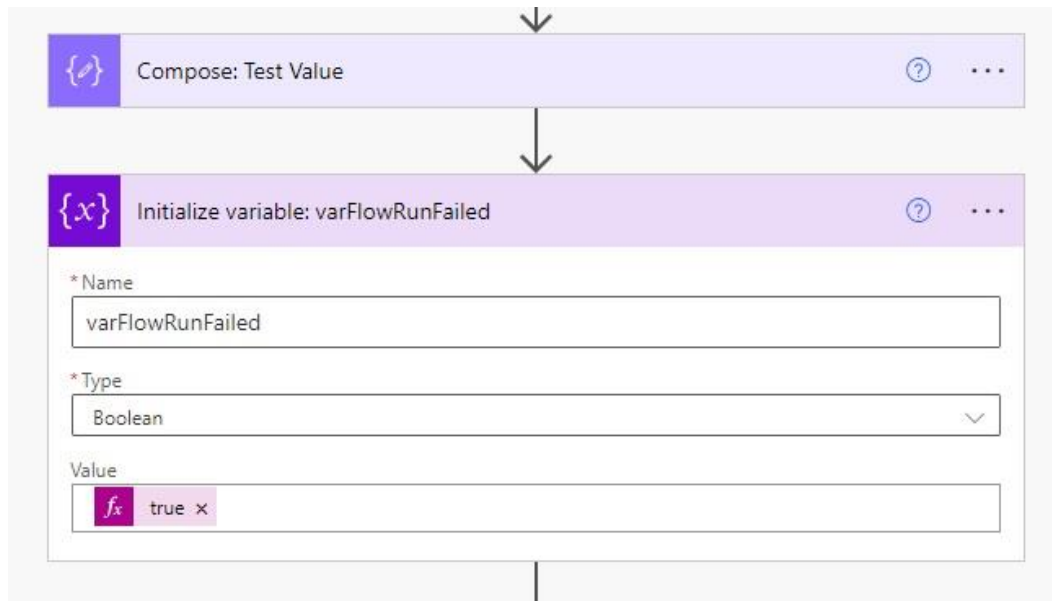

We only want to run the initialize variable action to if the previous action failed. Click the three dots on the initialize variable action and select *Configure run after*.

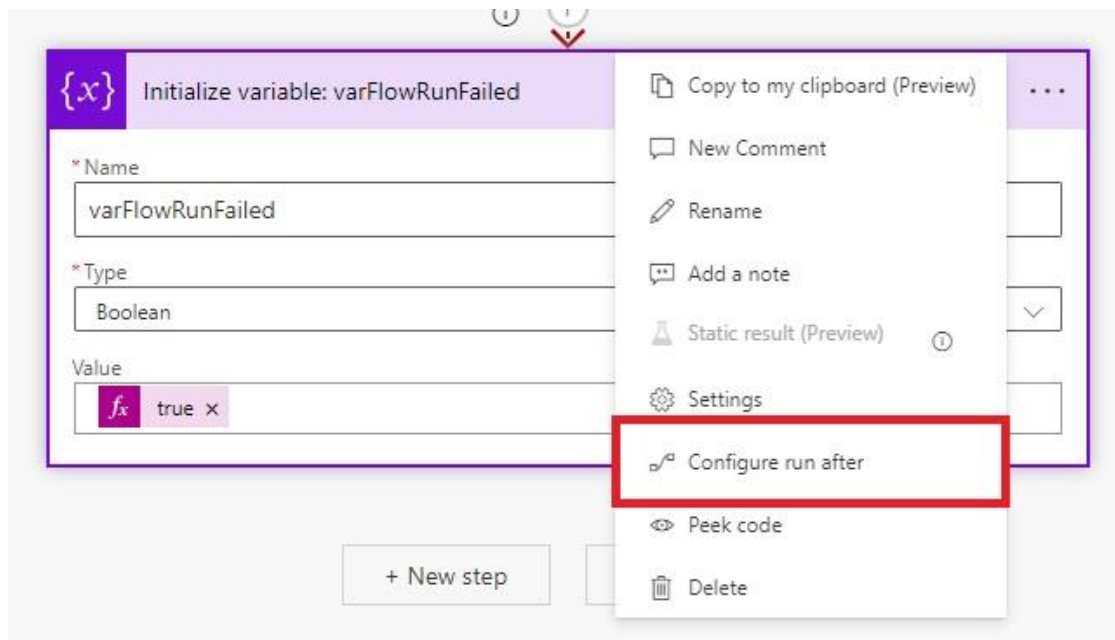

Setup the *configure run after* options as shown below. If the previous flow action fails, the Initialize variable action will run. Or if the previous flow action succeeds, this action will be skipped.

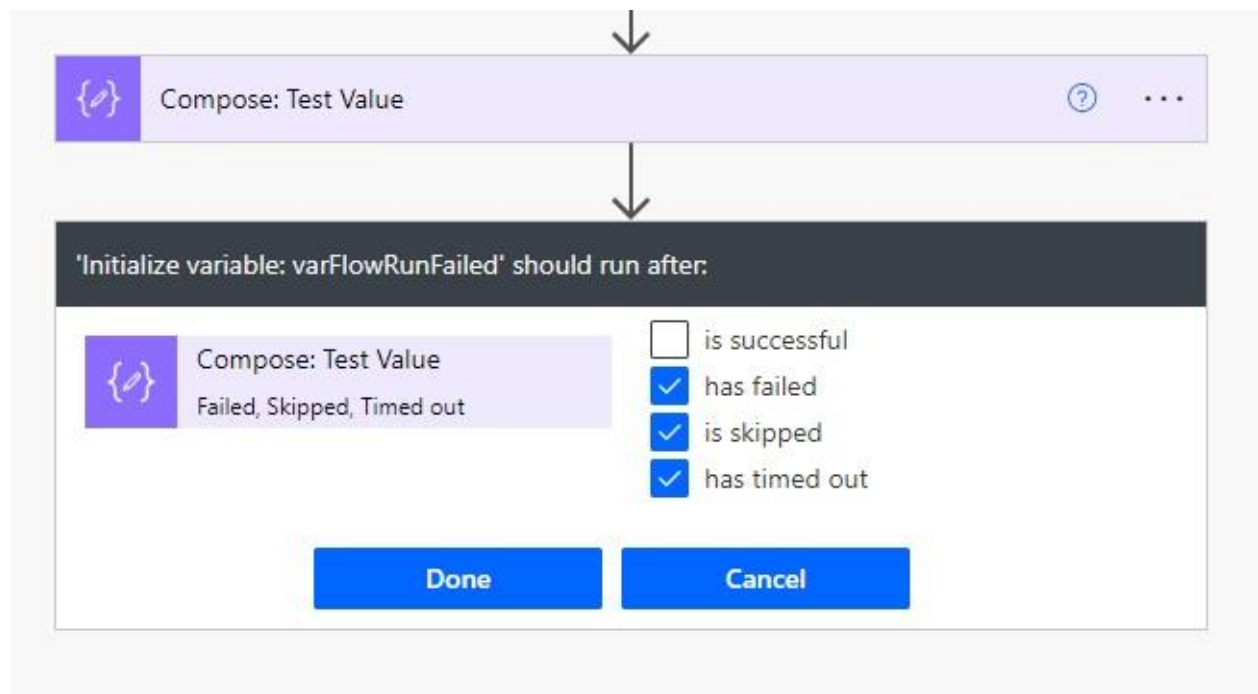

Finally Action

Insert an Office 365 Outlook: Send an email (V2) action to send a notification that the flow completed.

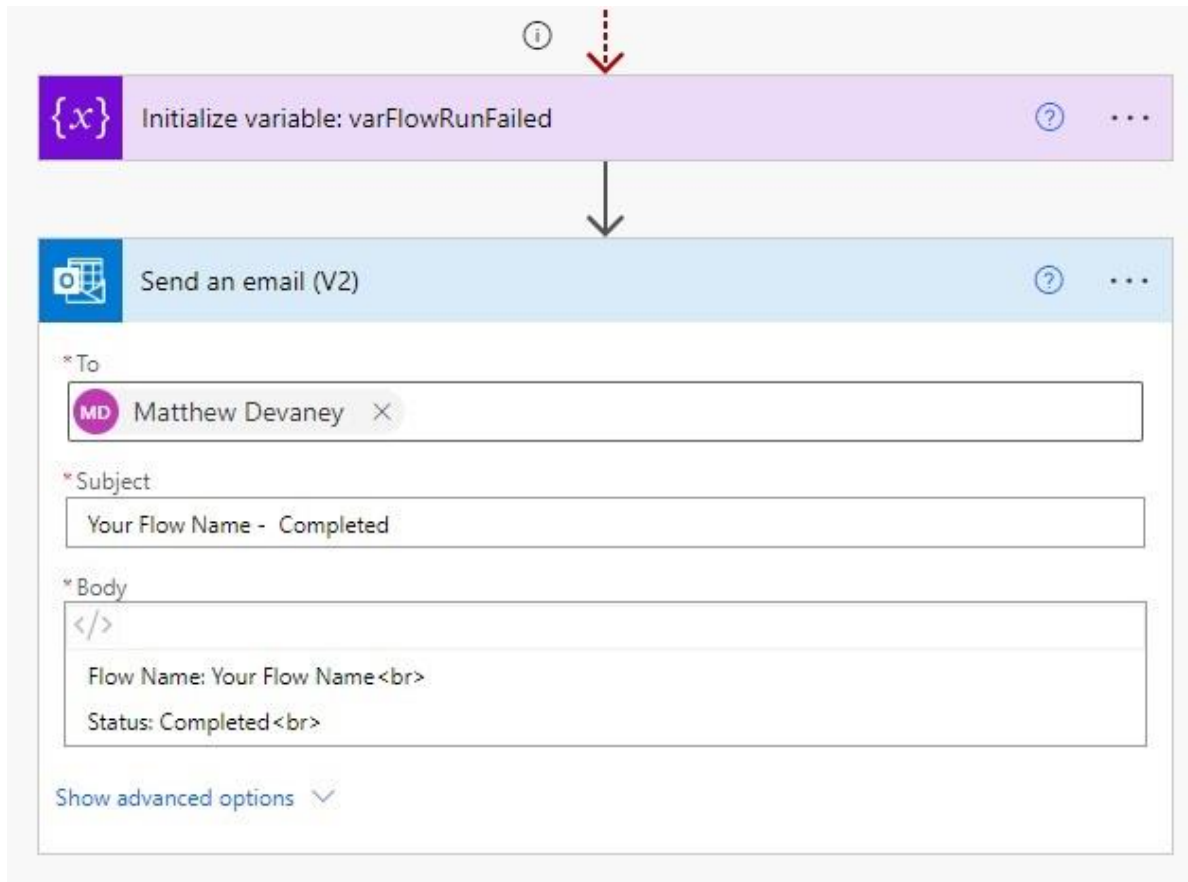

The last step on our Try, Catch, Finally pattern will always run regardless of whether the Compose (try) action succeeded or failed. Go to the configure run after menu and check all of the checkboxes.

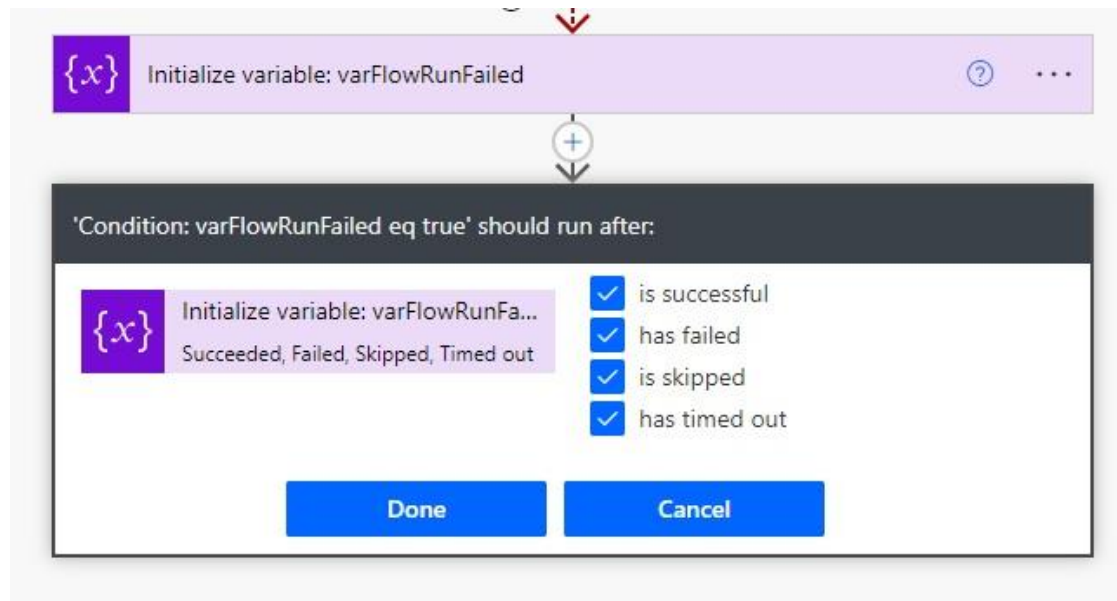

Test The Try, Catch, Finally Pattern

To see how the try, catch, finally pattern works, give the flow it a test run. The Compose (try) action will fail, the Initialize variable (catch) action handles the error and the Send an email (finally) action runs afterwards.

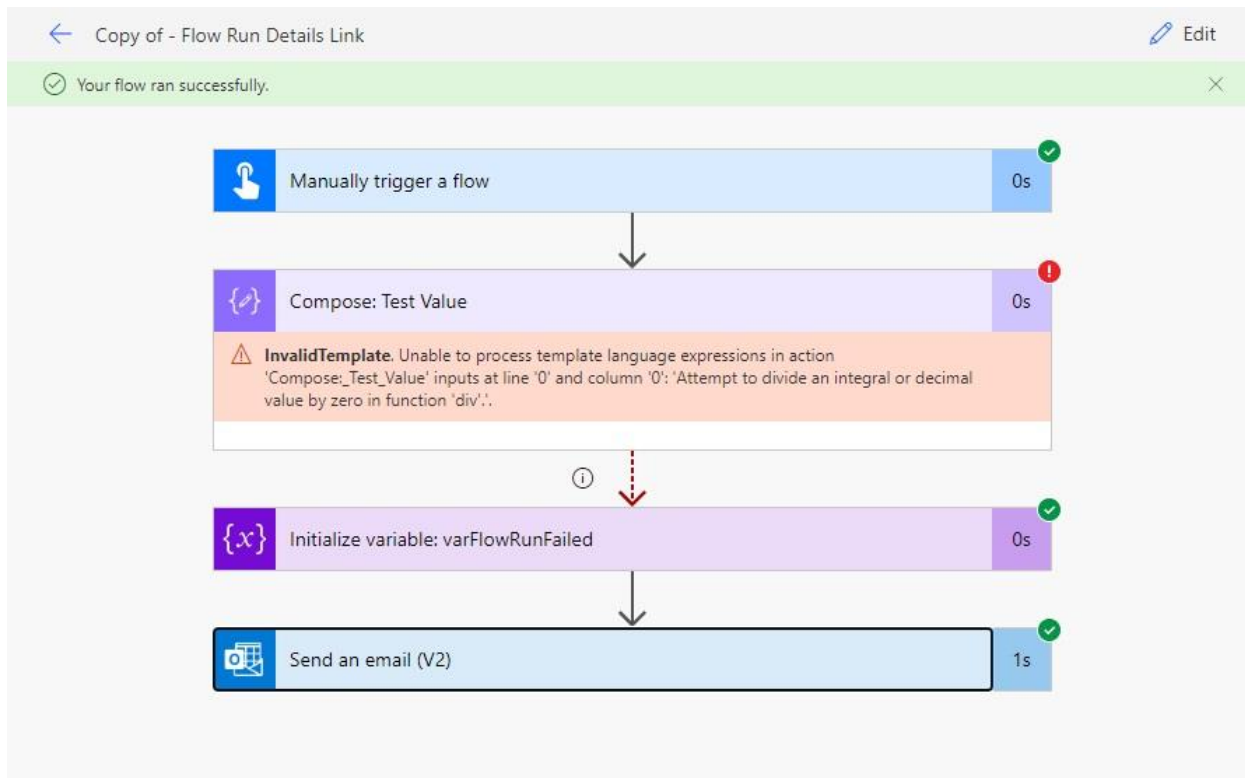

Pattern #2: Terminate Flow Success or Failure Pattern

When the test flow run is completed we see the notification “your flow run successfully” appear. This is not true. Our flow’s Compose action failed so the notification should say “flow run failed” instead. Next we’ll improve our error handling to show the proper result.

Remove the Send an email (V2) action. Then replace it with the [Condition action](#) where the variable *varFlowRunFailed* is equal to *true*.

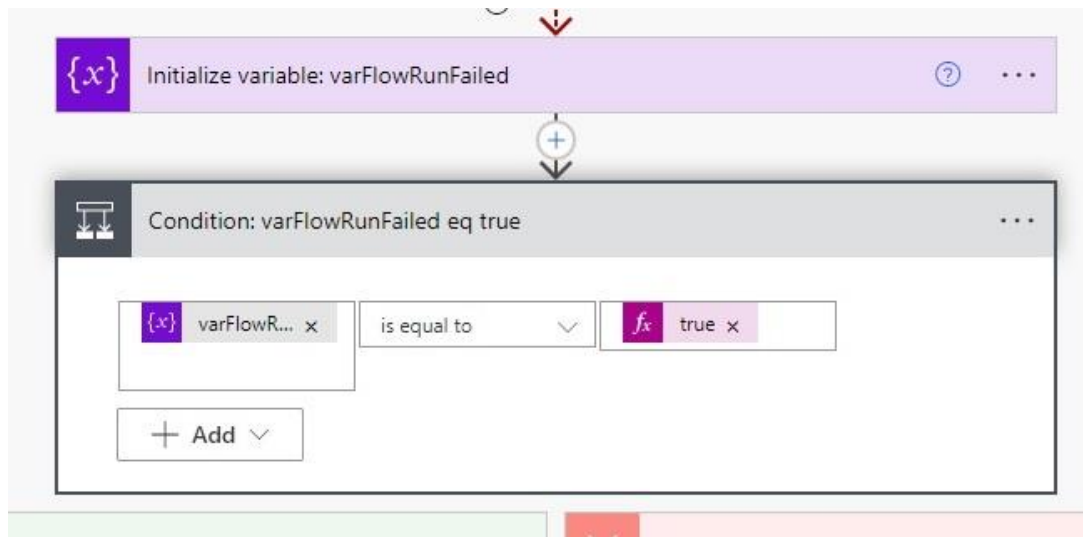

Check all of the checkboxes in the configure the Condition action’s run after settings.

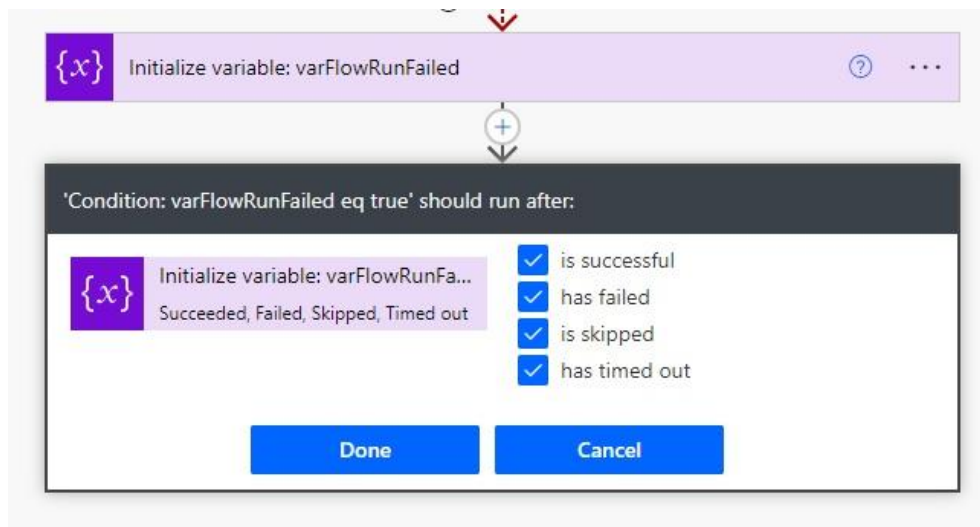

If `varFlowRunFailed` equals true, send an email notification that the flow failed. Then insert a Terminate action afterwards. Set the Terminate status to *Failed*.

✓ If yes

Send an email (V2): Failure

*To

MD Matthew Devaney

* Subject

Your Flow Name - Failure

* Body

</>

Flow Name: Your Flow Name

Status: Failure

Show advanced options

+

Terminate: Failure

*Status

Failed

Code

Enter error code

Message

Enter error message

Add an action

Pattern #2: Terminate Flow Success or Failure Pattern

12

Otherwise, when *varFlowRunFailed* is not equal to true send an email and terminate the flow successfully.

The screenshot displays a flow designer interface with the following components:

- Condition Step:** A red header bar with a close icon and the text "If no".
- Action Step 1:** A blue header bar with an email icon and the text "Send an email (V2): Flow Success".
 - *To:** A text box containing "mbdevaney@gmail.com" with a blue circular icon containing the letter "M" and a close icon.
 - *Subject:** A text box containing "Your Flow Name - Success".
 - *Body:** A text area with a code editor icon (</>) and the text "Flow Name: Test Flow
Status: Success".
 - Show advanced options:** A link with a downward arrow.
- Flow Connector:** A circular icon with a plus sign and a downward arrow.
- Action Step 2:** A red header bar with a document icon and the text "Terminate: Success".
 - *Status:** A dropdown menu with the text "Succeeded" and a downward arrow.
- Footer:** A blue icon with a downward arrow and the text "Add an action".

Test The Terminate Flow Pattern

Run a test of the updated flow. Now the flow properly shows the message “flow run failed.”

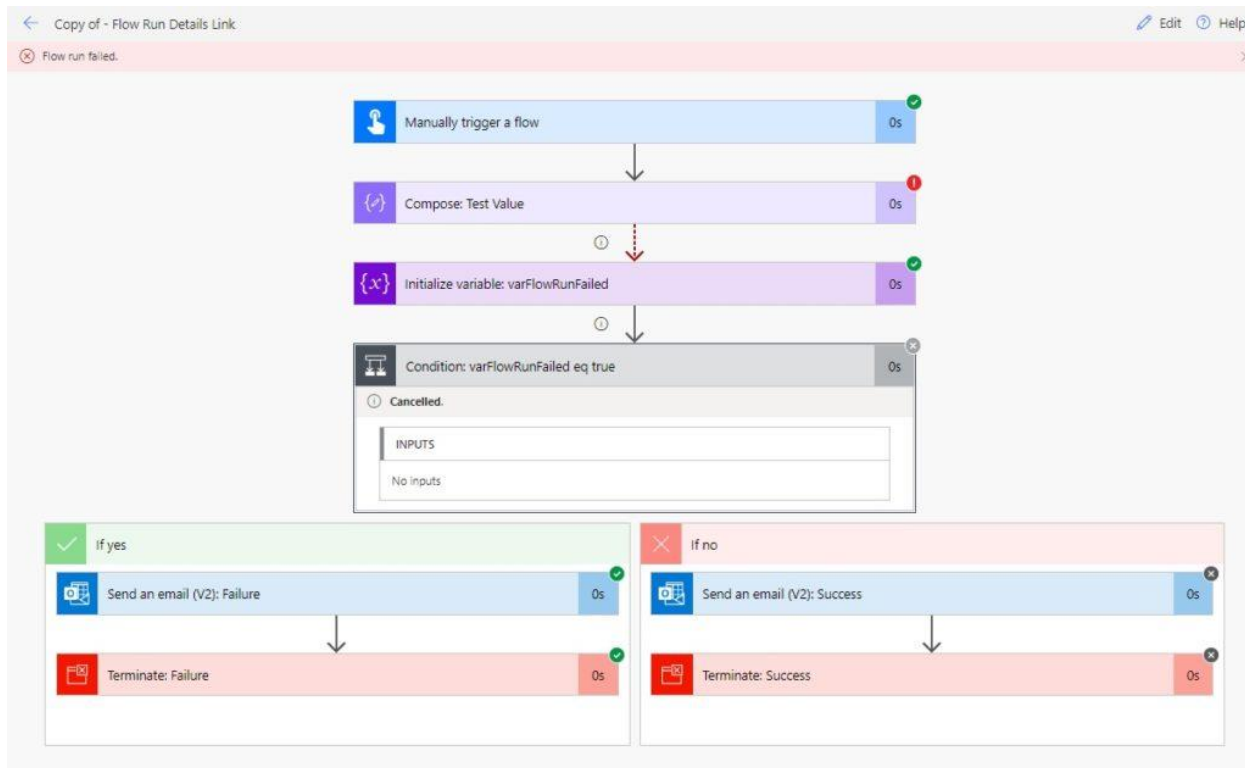

Pattern #3: Get Flow Run Details URL Pattern

When a flow fails we want to inspect the flow run details to see why it failed and fix the problem. Finding the specific flow run that failed can be difficult in Power Automate. To make it easier we can send a link to the flow run details in the failure notification email.

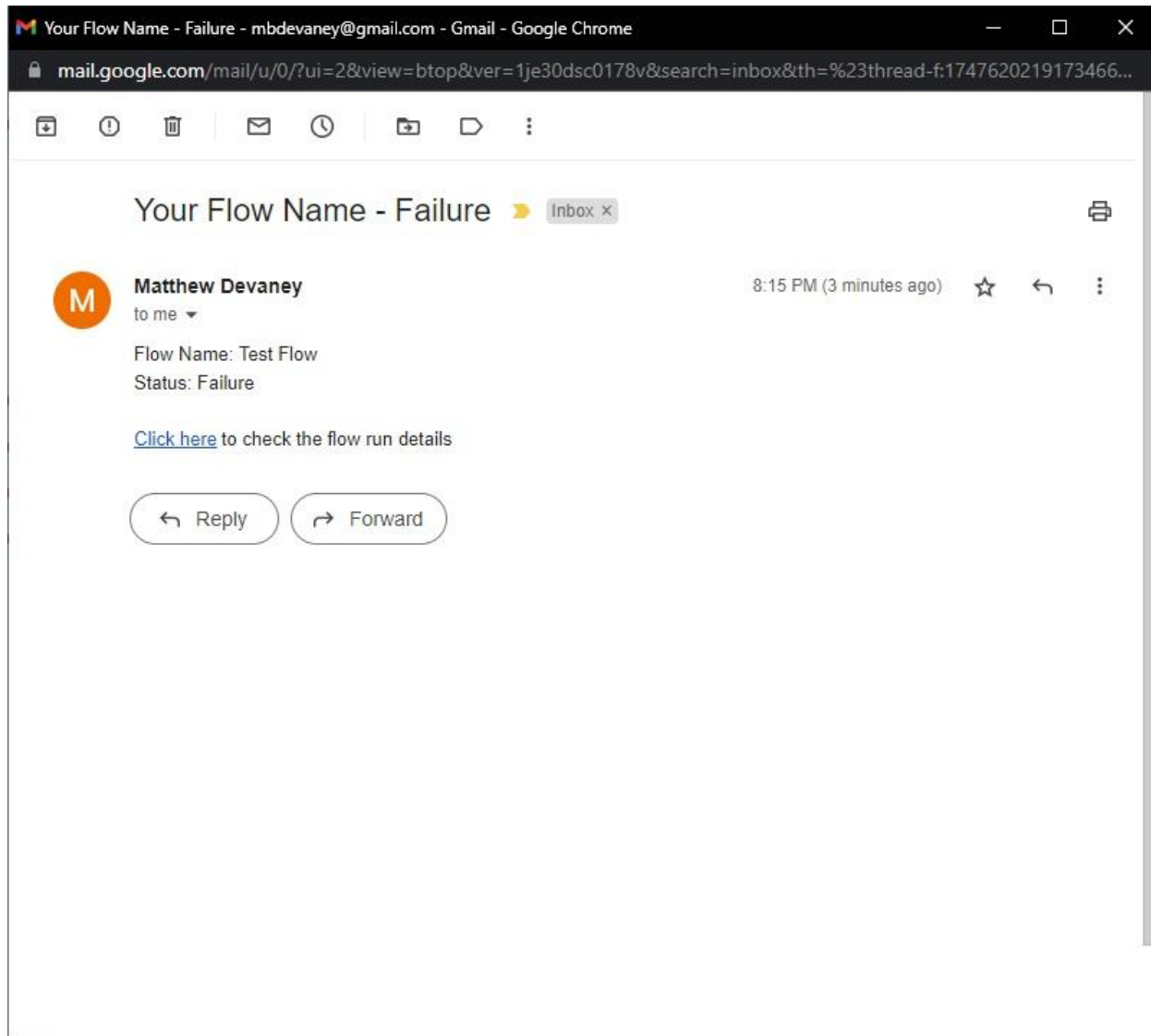

When the email recipient opens the link they are navigated to the flow run details where they can quickly identify what went wrong

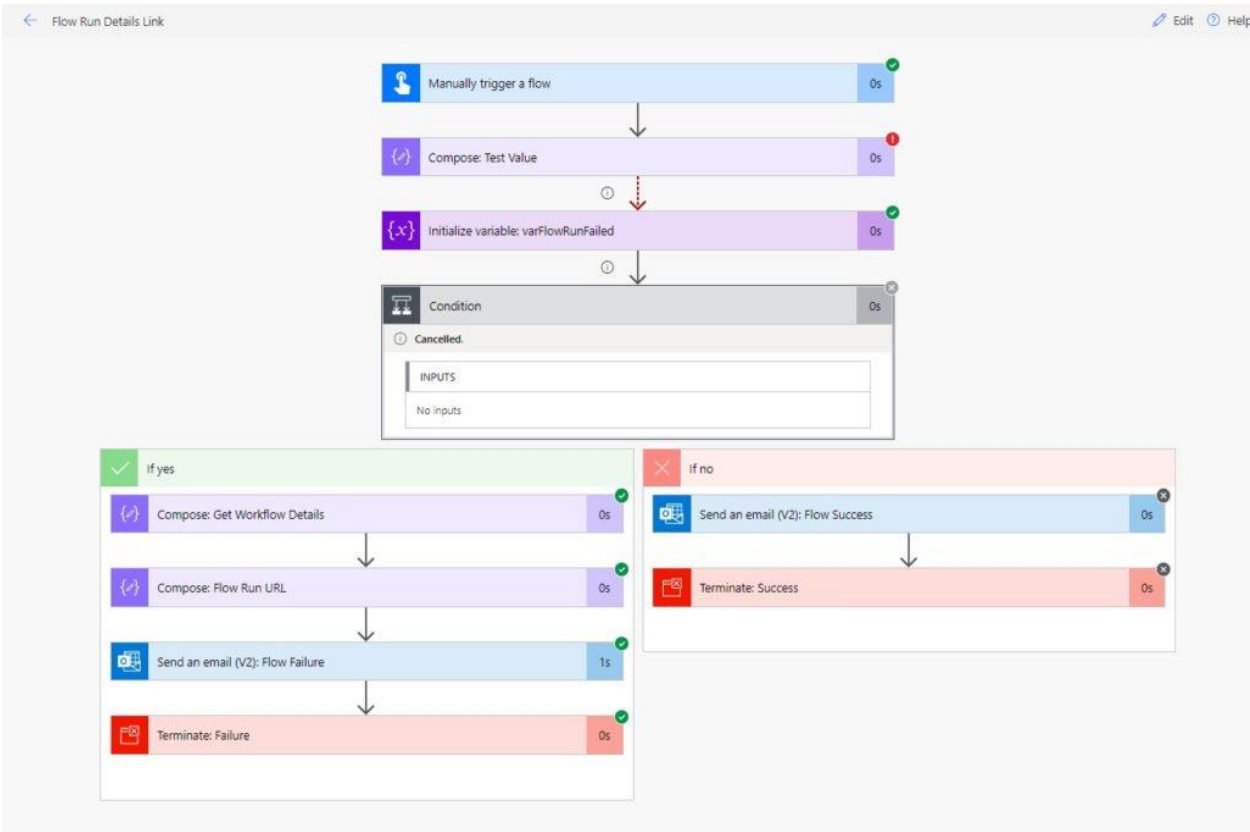

Build The Flow Run Details URL

Go to the flow’s If yes condition an add a Compose action.

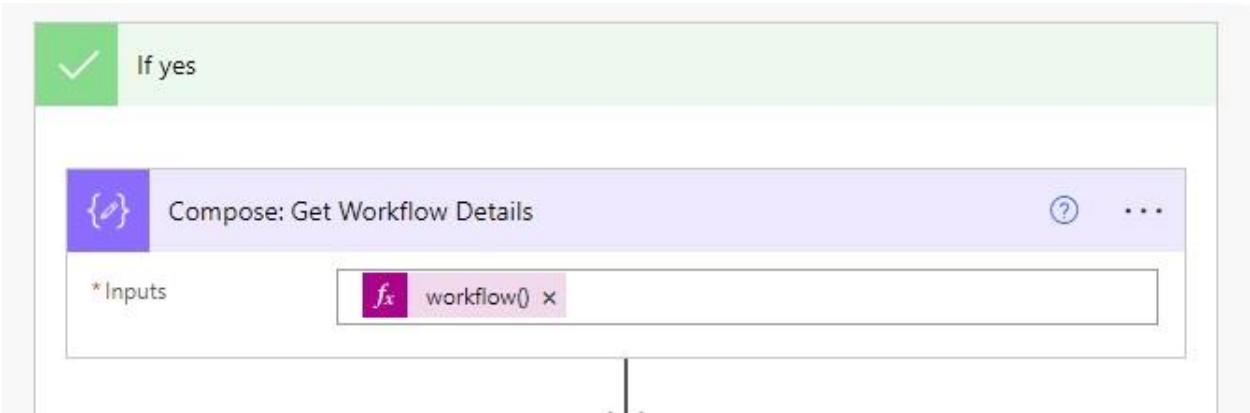

Use the [workflow function](#) to get details about the workflow itself.

```
workflow()
```

Then insert another Compose action to build the flow run URL.

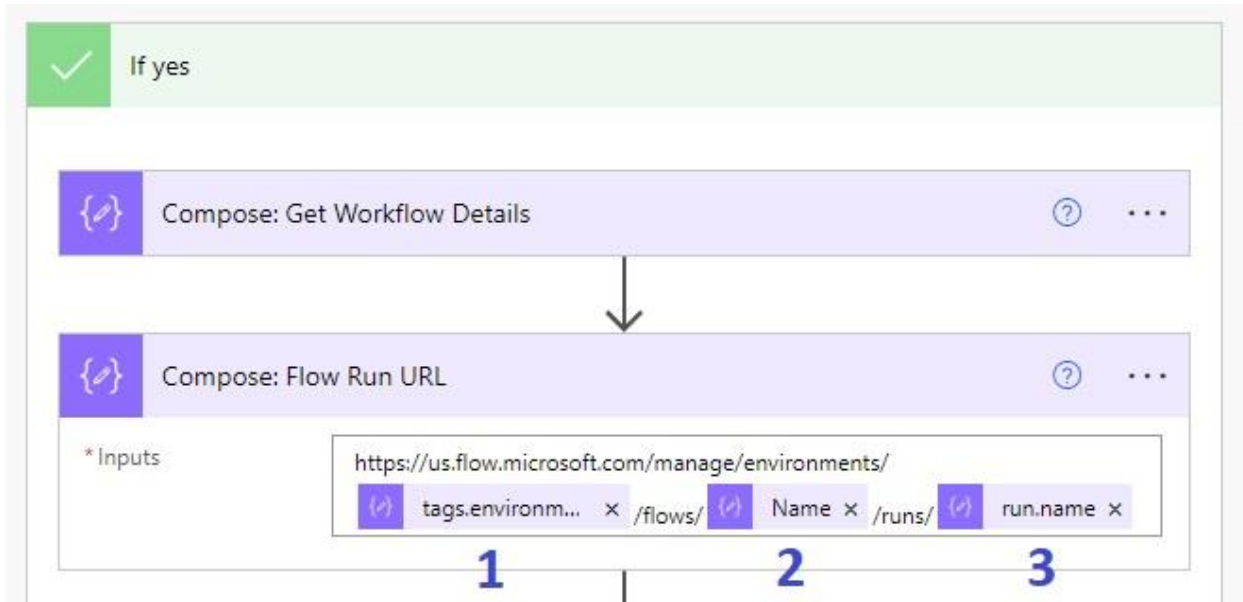

Flow expression #1 gets the *environment*'s unique identifier.

```
outputs('Compose:_Get_Workflow_Details')['tags']['environmentName']
```

Flow expression #2 extracts the *flow*'s unique identifier.

```
outputs('Compose:_Get_Workflow_Details')['name']
```

Flow expression #3 finds the *flow run*'s unique identifier.

```
outputs('Compose:_Get_Workflow_Details')['run']['name']
```

Send Failure Notification Email With Flow Run Link

The final step is to include the flow run url as a clickable link in the failure notification email.

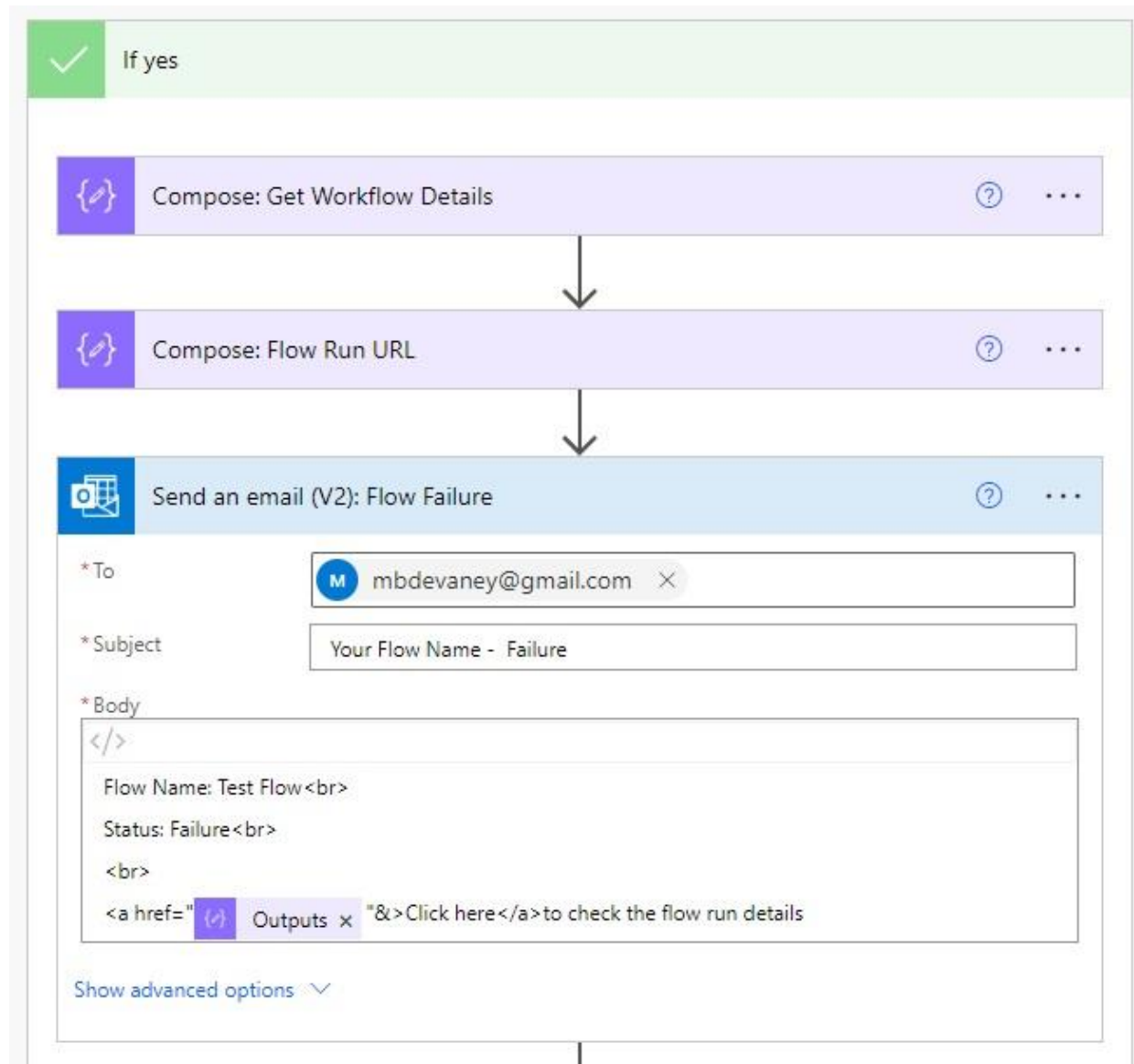

Write this HTML code in the body the email and use the Compose action inside the [a tag](#).

```
<a href="outputs('Compose:_Get_Workflow_URL')">Click here</a>to check the flow run details
```

Now the failure notification email contains a link to the flow run.

